



Description

The MultiXplo DG-TX7 intelligent catalytic based flammable gas detector is used to detect a wide range of gases, including hydrogen (H₂). The device has been designed for ease of installation, operation and maintenance in testing environments.

The DG-TX7 employs a pair of OXYCOL catalytic sensors in a compensated circuitry in order to provide reliable flammable gas detection in harsh environments, as long as oxygen is present. The intelligent, microprocessor driven unit is fully configurable using a wireless handheld terminal (TLU) or optionally via HART giving true flexibility to the installer. Parameters such as relay operation and alarm levels are all set via the TLU, hazardous area approved handheld unit.

In addition, the sensor element is protected by the onboard electronics to prevent exposure to over-range LEL gas concentrations. This helps reduce ongoing maintenance and service costs.

The user can select between 4-20 and 0-22 mA depending on system requirements. The unit may be interfaced directly with a wide range of panels, controllers and PLC's etc.

Device status, including measured gas level is indicated on a color coded 4 digit LED display.



Flexible Configuration
Reduced Maintenance
Over-range LEL Sensor Protection



TLU Wireless (IR)
Handheld Terminal



Applications

- ▶ Refineries
- ▶ Offshore Drilling and Production Platforms
- ▶ Processing and Storage Plants
- ▶ Chemical Plants

Features

- ▶ Detects virtually all flammable gases
- ▶ Computer matched poison resistant catalytic sensors
- ▶ Over-range LEL sensor protection
- ▶ Wireless, non intrusive testing by a single technician using TLU
- ▶ Hand held maintenance terminal
- ▶ "No-touch" field cabling
- ▶ HART® output option available

Benefits

- Detects Hydrogen, unlike IR detectors
- Excellent stability over a wide operating temperature range
- Reduced service and maintenance costs
- Reduced service costs
- End to end loop testing
- Detector can be replaced without disassembling the cable glands
- Full configuration and diagnostics over non-proprietary interface

Technical Data

General

Technology: Low temperature oxidation process, Oxycol™

Detects: Flammable Gases

Range: 0 to 100% LEL

Calibration: With calibration gas

Performance

Response Time: T90 < 15 s (Methane)

Zero Drift: ±3% full scale deflection

Accuracy: ±5% full scale deflection

Repeatability: ±1% full scale deflection

Sensor Life: Better than 5 years

Output Signal

Standard: 4-20 mA, max load impedance 700 Ohm (Std.)
2 x configurable Relays max 1A / 30V

Option HART®: HART Protocol (7th edition) (pending)

Option: 0-22mA (User configurable)

Option: Lonworks (Syntel)

Local Display: 4 digit LED display and backlight color status

Electrical

Power Supply: 24V DC, range (18-28V DC)

Power Consumption: 4W normal

Connection: 0.14 mm² (28 AWG) - 1.5mm² (16 AWG)
Shielded cable recommended.

Environmental

Storage: -40°C to +70°C (-40°F to +158°F)

Operating: -40°C to +65°C (-40°F to +149°F)

Option: Sunshade, max. temp. 85°C (185°F)

Humidity: 0-95% RH (non-condensing)

Pressure: Atmospheric pressure +/- 10%

Ingress: IP66

RFI/EMI: Complies with EN50270

Housing

Material: 316 L stainless steel

Weight: 4kg (8 lbs)

Approvals

ATEX: II 2 G Ex d IIC T6 Gb (-40°C to +65°C)

Certificate Number: LCIE 11 ATEX 3081 X

IECEX: Ex d IIC T6 Gb
IECEX LCI 11.0060X

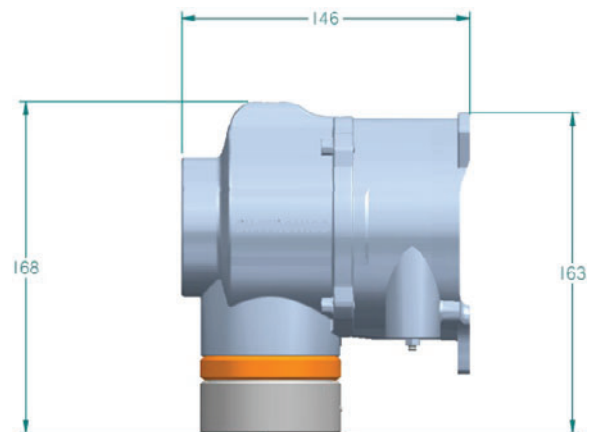

Conformities

EN60079-29-1 (performance)
EN50271 (software)

Accessories

TLU600: Infrared remote control unit

AS008: Sun shade

AS005: Calibration cup

AS011-2: Sample flow housing

AS019: Splash guard

CAL-K1C-xxDF-1A1-00: Calibration kit

AS047: Display protection

Other Products (Stainless Steel Range)

DGI-TT7-E: MultiTox, Toxic (EC Cell) Gas Detector

DG-TT7-S: MultiTox, Solid-State (MOS) Gas Detector

DF-TV7: MultiFlame, Flame Detector

Specifications subject to change without notice



Tel: 713-559-9200
Toll Free: 888-367-4286
Fax: 281-292-2860
Email: sales@detcon.com
Web: www.detcon.com

ISO 9001: 2008
Certified